

(III) Bancollan V-Belt (VC · DC)

1. An Introduction

Ideally suited for machines with a light load, the Bancollan V-belt has received rave reviews from a variety of clients. Recently, its range of applications has been expanded to include

general industry, and it is said to have set the standard for V-belts in the field of light loads.

Structure and Features

· VC (Cogs on the inner side)

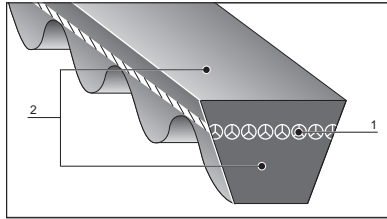

· DC (Cogs on both sides)

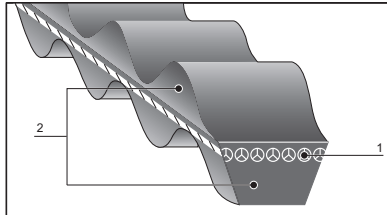

1. Tensile members (polyamide wires)
2. Upper section of rubber · Lower section of rubber (polyurethane rubber)

The Bancollan V-belt includes the following features.

■ Economic Transmission

Because it is made of polyurethane, which has a high transmission factor and flexibility, there is little transmission loss or wasted power.

■ Miniaturized Design

Due to the effects of the cogs and the belt's outstanding flexibility, it meshes smoothly with the pulley, so that it can be used even in relatively smaller spaces.

■ Clean Transmission

Because the belt is made of polyurethane, which has an outstanding durability, there is essentially no wear or tear, meaning that this belt is ideal for transmission systems that require clean transmission.

■ No Need to Perform Re-tensioning

Because of its polyamide wires, which display high strength, low elongation, and limited bending fatigue, elongation of the belt during operations is kept to a minimum, so that there is basically no need to perform re-tensioning.

Uses

Home Appliances

Sewing machines, pencil sharpeners, vacuum cleaners, dishwashers

Office Equipment · Laser Equipment

Typewriters, terminals, computer fans, slide and film projectors

Miniature Machine Tools · Power Tools

Lathes, drilling machines, grinding machines, and power diggers

Energy Conservation Equipment

Automated packaging machinery, automated vending machines, automatic doors, cash-counting machines, automated shoe shiners, ticket vending machines

Chemical Instruments

Agitators, dressers, winders, centrifugal separators

Others

Massaging machinery, radio control equipment (cars, helicopters), conveyer equipment (for coins, cards)

Belt Dimensions

· Profile Dimensions (6-type)

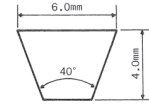

Identical to the dimensions of the VC and DC types.

· Example of Belt Labeling

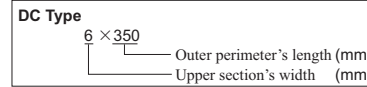
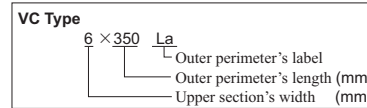

Labeling of the dimensions appears on the backs of VC-type belts, yet not on DC-type belts.

Dimensions of the Pulley's Teeth Grooves

Pulleys of the following dimensions should be used with the Bancollan V-belt.

Teeth Groove Dimensions (for use with the 6-type)

Unit: mm

Pulley's Outer Diameter do	a (°)	W	h	f
Greater than 16, less than 20	±30	±0.05		
Greater than 20, less than 50	36	5.6	5.0	2.0
Greater than 50	38			

For information on pulleys for other belts besides the 6-type, or for information on pulleys for special applications, please inquire with our company.

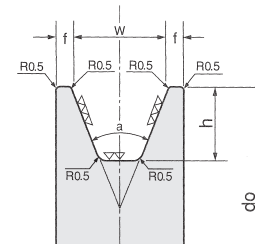

Table 1 Belt's Dimensions

Unit: mm

VC-Type 6				DC-Type 6	
Nominal dimensions	Outer perimeter's length (mm)	Nominal dimensions	Outer perimeter's length (mm)	Nominal dimensions	Outer perimeter's length (mm)
6×207	207.0	6×470	470.0	6×200	200.0
6×220	220.0	6×480	480.0	6×210	210.0
6×232	232.0	6×485	485.0	6×230	230.0
6×250	250.0	6×490	490.0	6×240	240.0
6×260	260.0	6×500	500.0	6×250	250.0
6×261	261.0	6×511	511.0	6×260	260.0
6×280	280.0	6×520	520.0	6×270	270.0
6×289	289.0	6×530	530.0	6×277	277.0
6×297	297.0	6×540	540.0	6×280	280.0
6×300	300.0	6×550	550.0	6×290	290.0
6×315	315.0	6×561	561.0	6×300	300.0
6×320	320.0	6×567	567.0	6×310	310.0
6×330	330.0	6×600	600.0	6×315	315.0
6×340	340.0	6×613	613.0	6×320	320.0
6×343	343.0	6×626	626.0	6×330	330.0
6×345	345.0	6×650	650.0	6×340	340.0
6×349	349.0	6×663	663.0	6×350	350.0
6×350	350.0	6×700	700.0	6×360	360.0
6×350	360.0	6×713	713.0	6×365	365.0
6×370	370.0	6×730	730.0	6×370	370.0
6×380	380.0	6×750	750.0	6×375	375.0
6×381	381.0	6×760	760.0	6×380	380.0
6×390	390.0	6×764	764.0	6×390	390.0
6×400	400.0	6×800	800.0	6×400	400.0
6×407	407.0	6×821	821.0	6×450	450.0
6×410	410.0	6×850	850.0	6×500	500.0
6×414	414.0	6×866	866.0	6×520	520.0
6×420	420.0			6×540	540.0
6×430	430.0				
6×432	432.0				
6×440	440.0				
6×444	444.0				
6×450	450.0				
6×450	460.0				
6×466	466.0				

Permitted Deviations in Dimensions

Unit: mm

	VC Type	DC Type
Upper section's width	6 ±0.2	6 ±0.3
Thickness	4 ±0.2	4 ±0.2
Length	less than 400	±2.0
	400 ~ less than 600	±2.0
	600 ~ less than 800	±2.5
	800 ~ less than 850	—
	±3.0	