

POINT : Motorized Toy

DIRECTION OF ROTATION

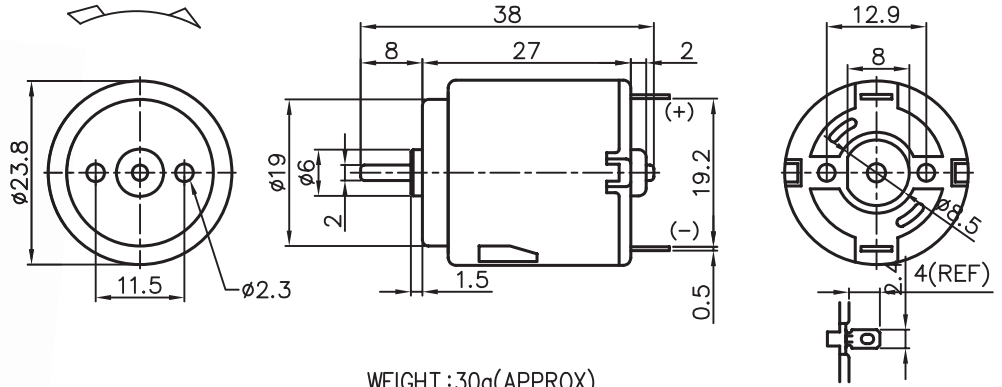

WEIGHT : 30g(APPROX)

MODEL	VOLTAGE		NO LOAD		AT MAXIMUM EFFICIENCY					STALL			
	OPERATING RANGE	NOMNAL	SPEED	CURRENT	SPEED	CURRENT	TORQUE	OUTPUT	EFF	CURRENT	TORQUE		
			rpm	A	rpm	A	g-cm	mN-m	W	%	A	g-cm	mN-m
FE-260-2670-N	1.5 - 3.0	1.5V CONSTANT	5100	0.180	3700	0.66	10.53	1.03	0.40	42.92	2.41	50.08	4.91
FE-260-2295-N	1.5 - 4.5	3.0V CONSTANT	8100	0.160	6800	0.63	13.96	1.37	0.98	53.91	2.62	73.29	7.19
FE-260-18130-N	1.5 - 4.5	3.0V CONSTANT	6100	0.100	4700	0.36	10.27	1.01	0.50	49.63	1.39	52.75	5.17
FE-260-08450-N	6.0 - 12.0	12.0V CONSTANT	7500	0.035	5500	0.11	10.32	1.01	0.60	46.63	0.35	42.00	4.12

