

# GEARED STEPPING MOTOR SRA06 SERIES

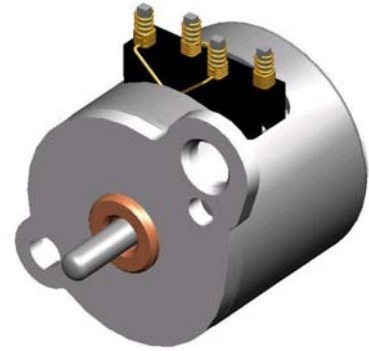

## Application

Precision Instruments  
DSC

MODEL	VOLTAGE		CURRENT	STEP ANGLE	PHASE	DRIVE MODE	MASS
	OPERATING RANGE	NOMINAL	A	9°	2	BI-POLAR	0.99g
<b>21SRA0605002</b>	3.8V~5.0V	4.6V	0.092/Phase				

## Specification 21SRA0605002

CONNECTION DIAGRAM

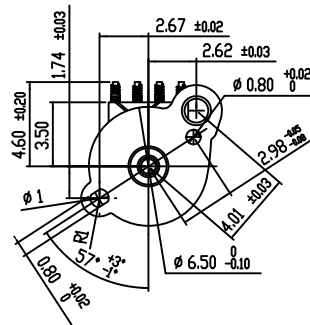
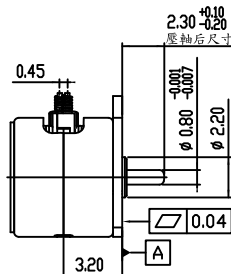
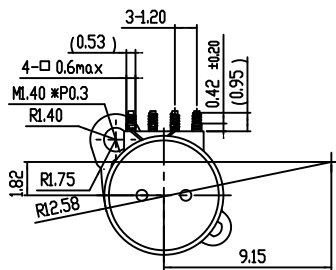
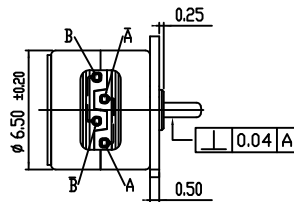
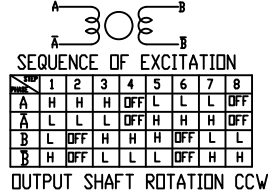

21SRA0605002 STEPPING MOTOR

VOLTAGE 4.6V  
RESISTANCE OF COIL 50Ω±7%  
1-2PHASE EXCITATION

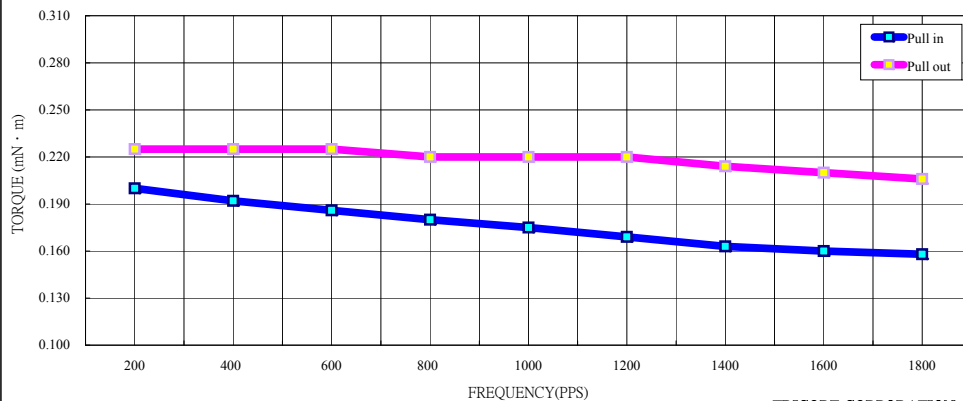

TRICORE CORPORATION